

# ENTRY-GUARD™ (P/N: ETG-SS-F)

Entry-Guard™ remote start switch. Green housing with red piezo momentary push button. Features one normally open contact and one normally closed contact.

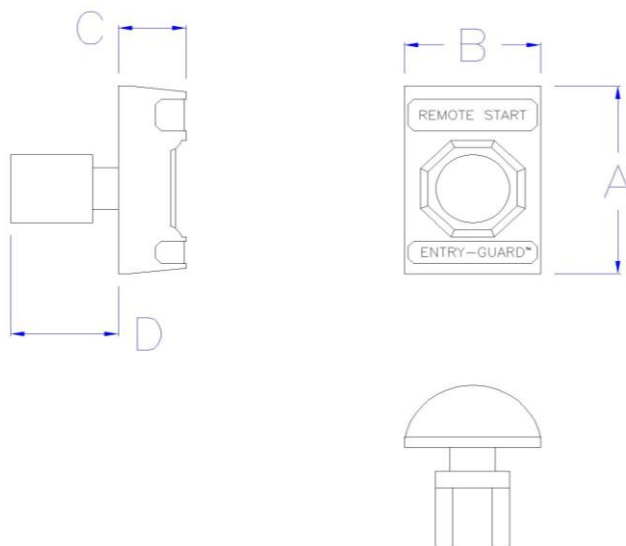

- Provides external or remote start feature
- Unique, curved design helps protect against accidental activation
- Small, light weight, impact resistant polymer housing

Specifications	
<b>Outside Dimensions</b>	A = Height: 4.87" [124mm]
	B = Width: 3.25" [82mm]
	C = Depth: 1.62" [41mm]
	D = Depth: 2.25" [57.1mm]
<b>Mounting Pattern</b>	Single gang outlet box compatible
<b>Rated Voltage</b>	250 VDC / 600 VAC
<b>Rated Current</b>	1 amp (DC) / 6 amps (AC)
<b>Weight</b>	1 lbs [0.45 kgs]

**KENTEK CORPORATION** 32 Broadway • Pittsfield, NH 03263 USA

Tel: 1 800-432-2323 Fax: 1 603-435-7441 Web: [kenteklaserstore.com](http://kenteklaserstore.com) Email: [info@kenteklaserstore.com](mailto:info@kenteklaserstore.com)